

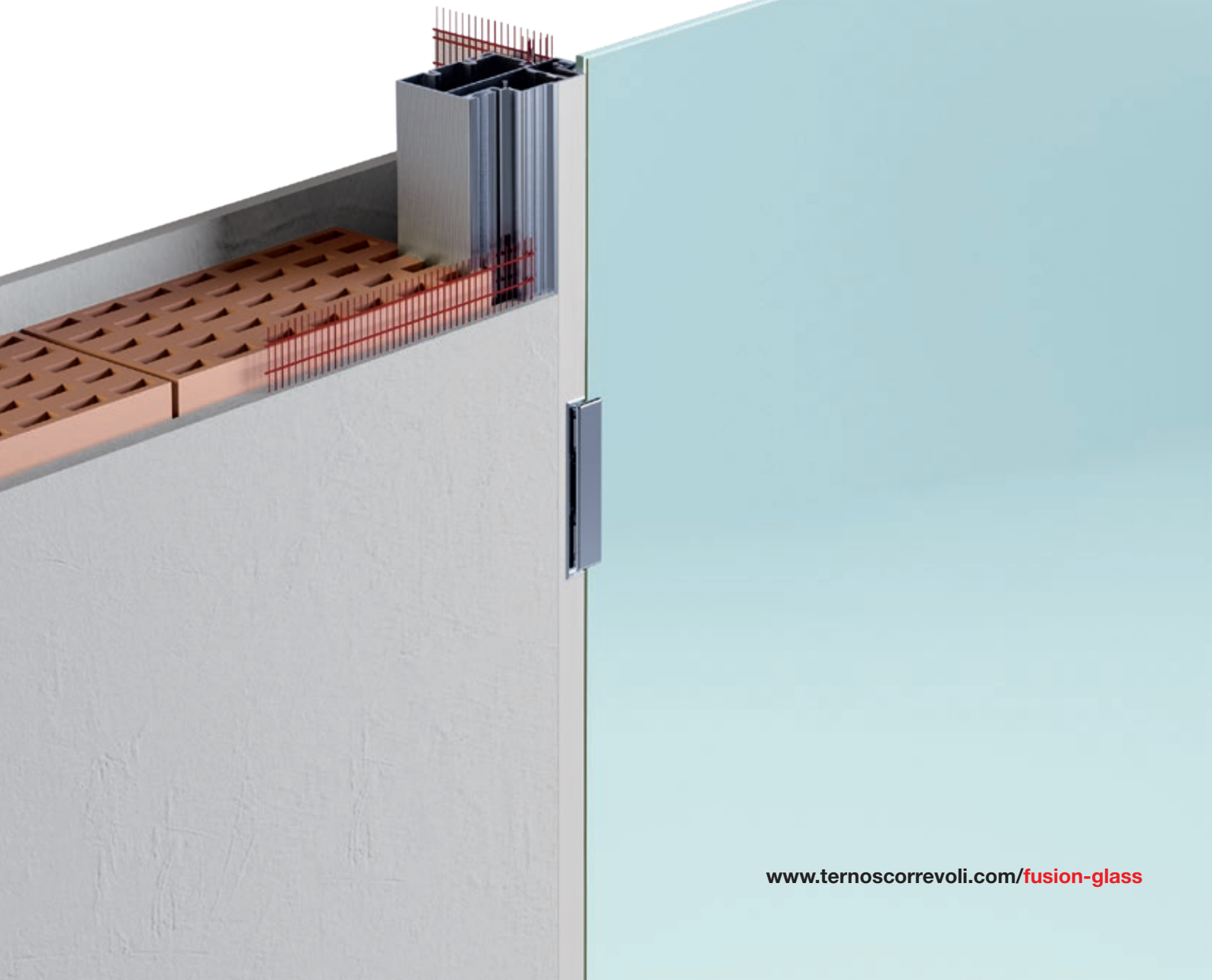

FUSION

GLASS

Flush swing glass door system
Sistema per porte battenti rasomuro in vetro



FUSION

GLASS

Fusion Glass is the new flush swing glass door system. The usage of best components allows a **quick and easy installation**.

Fusion Glass è il sistema per porte battenti rasomuro in vetro. L'utilizzo dei migliori componenti permette un **rapido montaggio e un'agevole posa**.



A new versatile system, for a unique design

Fusion Glass flush swing system is used with **glass doors from 8 ÷ 10 mm thickness.**

It's possible to supply frames dedicated to standard door sizes.

Alternatively, it's possible to realize frames according to special sizes requirements, providing information of height, width and quantity of hinges to use.

Un nuovo sistema versatile, per un design unico

Il sistema per porte battenti rasomuro **Fusion Glass** si può utilizzare con **porte in vetro con spessore 8 ÷ 10 mm.**

Il sistema è adattabile sia a telai lavorati con misure standard, sia a telai su misura, fornendo le dimensioni di altezza e larghezza ed il numero di cerniere.



Fusion		COMPLETE BOX KIT / KIT COMPLETO IN SCATOLA			
K	Complete kit / Kit completo				
		0435	Door opening / Vano passaggio 700 mm		
		0436	Door opening / Vano passaggio 800 mm		
		0437	Door opening / Vano passaggio 900 mm		
		0438	Door opening / Vano passaggio 1000 mm		
				4	Hinge (type 1) / Cerniera (tipo 1) SIMONSWERK
				1	Opening 1 / Right "black gasket" (pull right - push left) Apertura 1 / Destra "guarnizione nera" (tirare destra - spingere sinistra)
				2	Opening 2 / Left "black gasket" (pull left - push right) Apertura 2 / Sinistra "guarnizione nera" (tirare sinistra - spingere destra)
				3	Opening 1 / Right "white gasket" (pull right - push left) Apertura 1 / Destra "guarnizione bianca" (tirare destra - spingere sinistra)
				4	Opening 2 / Left "white gasket" (pull left - push right) Apertura 2 / Sinistra "guarnizione bianca" (tirare sinistra - spingere destra)
				01	Anodized Silver Argento
				14	Anodized Black Nero

EXAMPLE / ESEMPIO

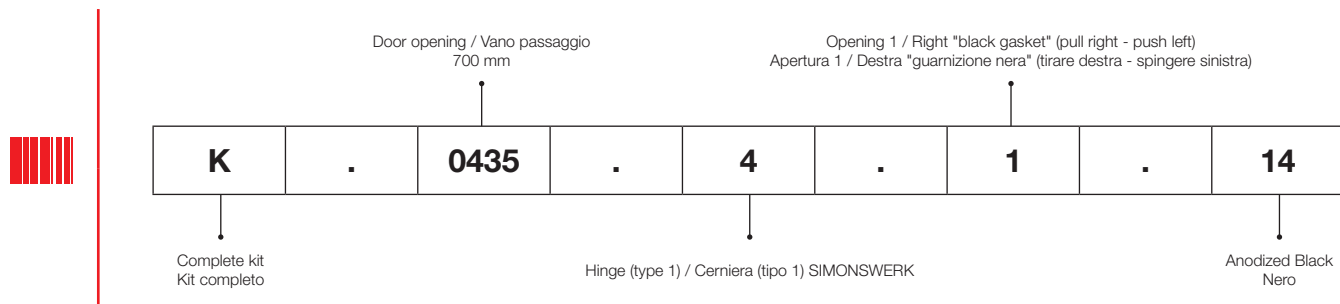

Tracks / Binari		ALUMINUM FINISHES CODES / CODICI FINITURE ALLUMINIO				
CODE / CODICE		FINISH COLOR / COLORE FINITURA				
8 00 0.0	 00 G	Row - Mill Finish / Neutro - Grezzo				STANDARD
8 01 0.0	 01 A	Anodized Silver / Argento				
8 14 0.0	 14 N	Anodized Black / Nero				

Fusion Glass



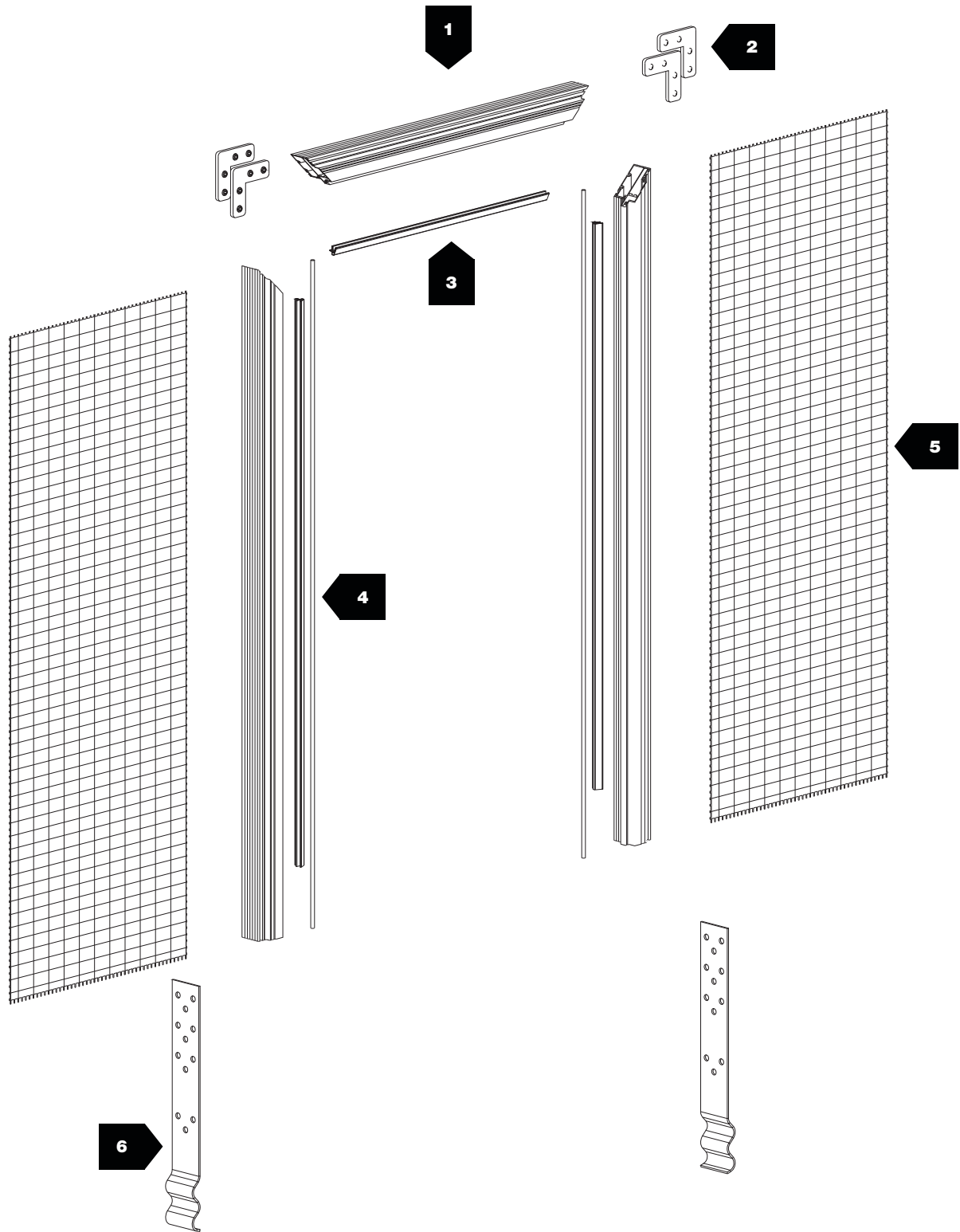



Flush swing glass door system
Sistema per porte battenti rasomuro in vetro



8 ÷ 10 mm

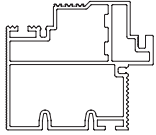
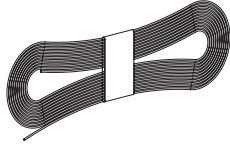
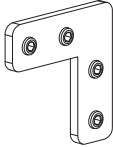
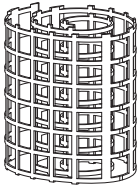

80 kg

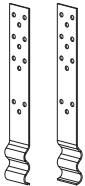
N°					N°				
1	2901 8 00 0.02901 8 01 0.02901 8 14 0.02901		—		4	2910		—	
2	446		—		5	2907		—	
3	2905		—		6	2908		—	

Fusion Glass

Flush swing glass door system
Sistema per porte battenti rasomuro in vetro

 **80 kg**

.01 Anodized Silver
Argento

.14 Anodized Black
Nero

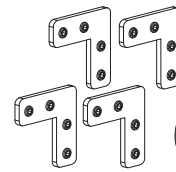
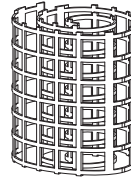
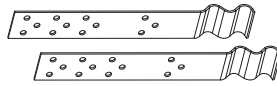
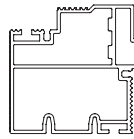

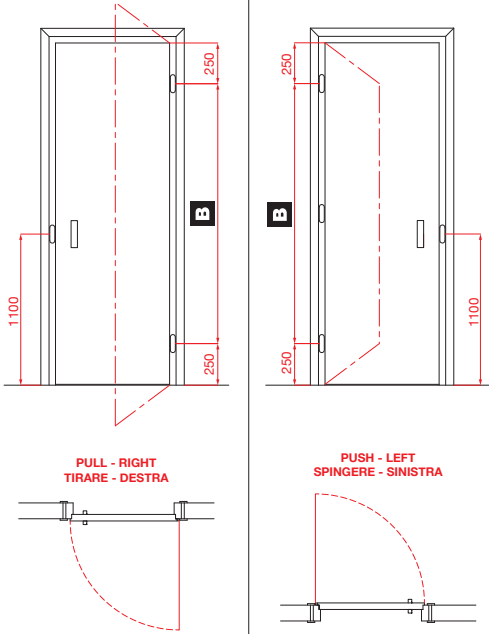
OPENING 1 APERTURA 1	KIT	MEASUREMENTS MISURE				
		GASKET / GUARNIZIONE	A	B	C	
 <p>PULL - RIGHT TIRARE - DESTRA</p> <p>PUSH - LEFT SPINGERE - SINISTRA</p>	K.0435.4.1.14	Black / Nera	2100	790	700	1x
	K.0436.4.1.14				800	1x
	K.0437.4.1.14				900	1x
	K.0438.4.1.14				1000	1x
	K.0435.4.3.01	White / Bianca			700	1x
	K.0436.4.3.01				800	1x
	K.0437.4.3.01				900	1x
	K.0438.4.3.01				1000	1x

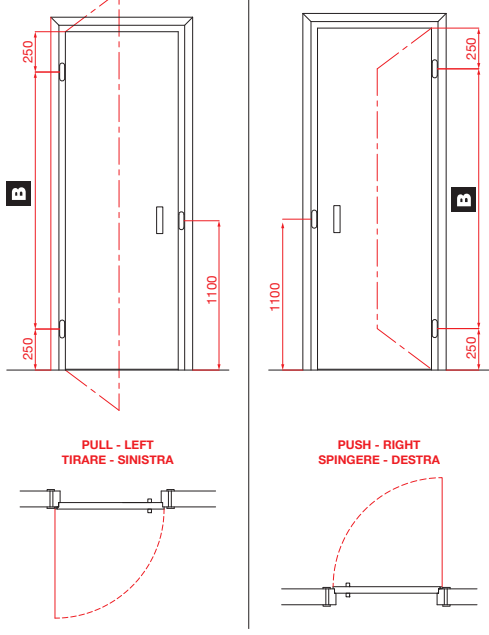
OPENING 2 APERTURA 2	KIT	MEASUREMENTS MISURE				
		GASKET / GUARNIZIONE	A	B	C	
 <p>PULL - LEFT TIRARE - SINISTRA</p> <p>PUSH - RIGHT SPINGERE - DESTRA</p>	K.0435.4.2.14	Black / Nera	2100	790	700	1x
	K.0436.4.2.14				800	1x
	K.0437.4.2.14				900	1x
	K.0438.4.2.14				1000	1x
	K.0435.4.4.01	White / Bianca			700	1x
	K.0436.4.4.01				800	1x
	K.0437.4.4.01				900	1x
	K.0438.4.4.01				1000	1x

MEASUREMENTS DESCRIPTION / DESCRIZIONI MISURE

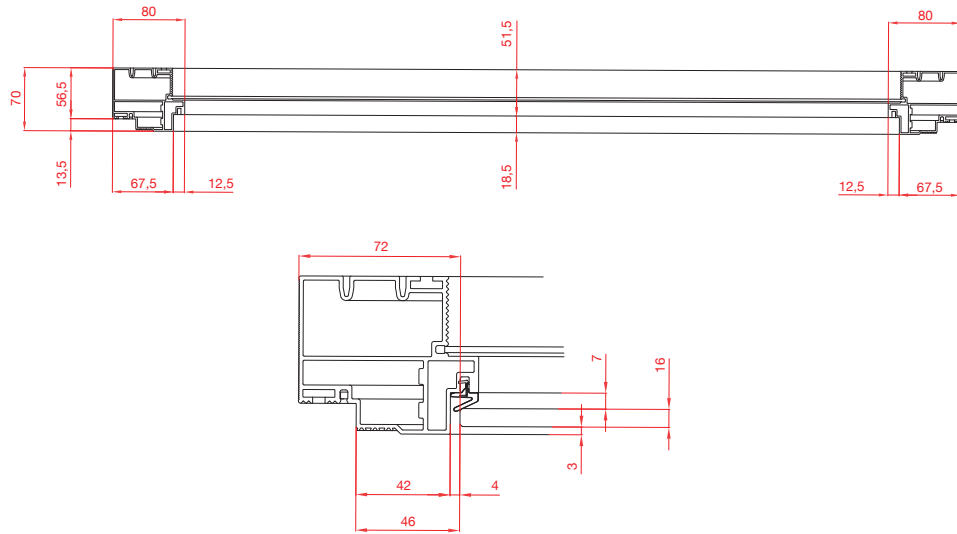

DOOR-CATCHER / INCONTRO SERRATURA



MANUFACTURER
PRODUTTORE

MODEL
MODELLO

MAGNETIC PLATE
KCM 25/G LOCK
CLOSING MAGNET
KCM 25 LOCK

SIMONSWERK

MAGNETIC PLATE
KCM 50/G LOCK
CLOSING MAGNET
KCM 50 LOCK

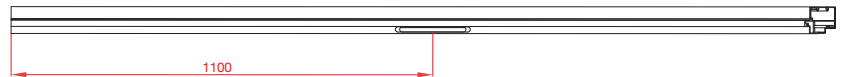

HINGES / CERNIERE



STANDARD

MANUFACTURER
PRODUTTORE

MODEL
MODELLO

HINGE SYSTEM
TECTUS TEG 310 2D 60

SIMONSWERK

HINGE SYSTEM
TECTUS TEG 310 2D 80



MASONRY APPLICATION / APPLICAZIONE SU MURATURA

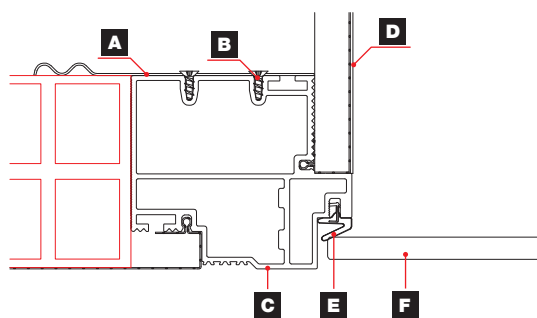
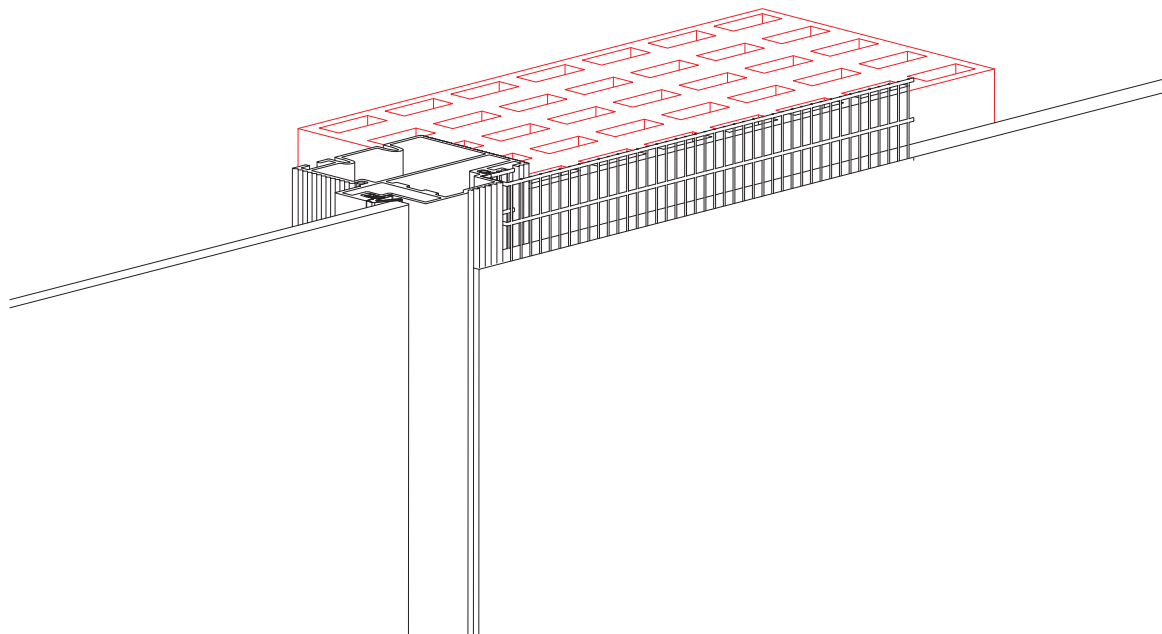

PUSHING OPENING
APERTURA A SPINGERE

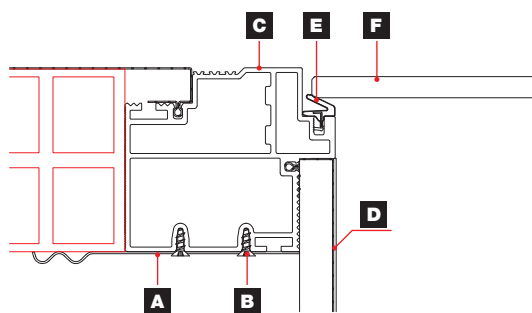

PULLING OPENING
APERTURA A TIRARE

A	ART. 2908
B	SCREW / VITE
C	ART. 2901
D	ART. 2907
E	ART. 2905
F	DOOR / ANTA

PLASTERBOARD APPLICATION / APPLICAZIONE SU CARTONGESSO

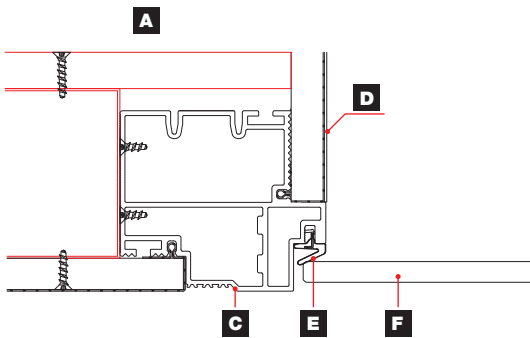
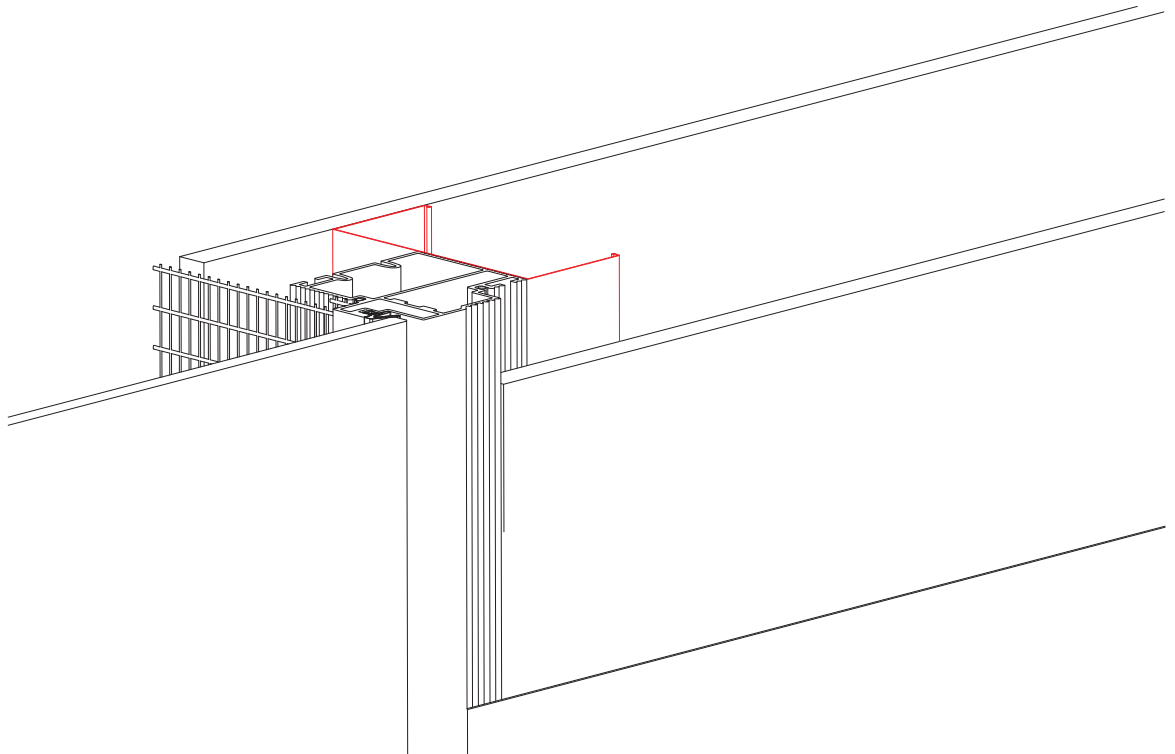

PUSHING OPENING
 APERTURA A SPINGERE

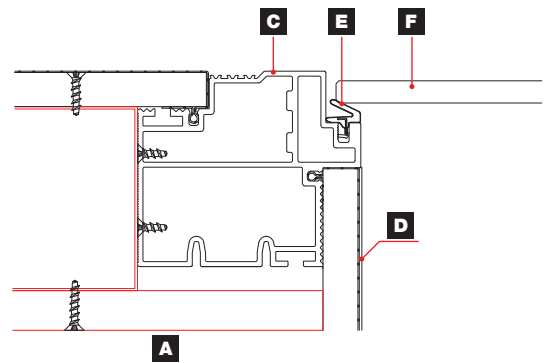

PULLING OPENING
 APERTURA A TIRARE

A	ART. 2908
B	SCREW / VITE
C	ART. 2901
D	ART. 2907
E	ART. 2905
F	DOOR / ANTA



Terno Scorrevoli S.p.A.

**Via Ravenna, 4 - 20814 Varedo (MB) ITALY
Phone +39 0362 543001 - Fax +39 0362 582290**

**terno@ternoscorrevoli.com
www.ternoscorrevoli.com**